

428340

Certified, Filed and or Recorded on
March 20, 2018 11:25 AMBENTON COUNTY MINNESOTA
CHERYL L. KANTOR
COUNTY RECORDERBy: BS

6-V-I

CERTIFICATE OF LOCATION OF GOVERNMENT CORNEREAST QUARTER Corner of Section 2, Township 38N, Range 31W
4TH Principal Meridian, State of Minnesota, County of Benton

At the corner location shown on the sketch:

☐ On _____ found a _____☐ left monument as found ☐ lowered monument ☐ removed monument (explain)☒ On 1-5-11 placed on 1/2" x 14" IP WITH RLS 19552 CAP IN PLACE
OF OLD FENCE POST.

NOTE: ALL TIES ARE 1/2" x 14" IP WITH REF RT CAP.

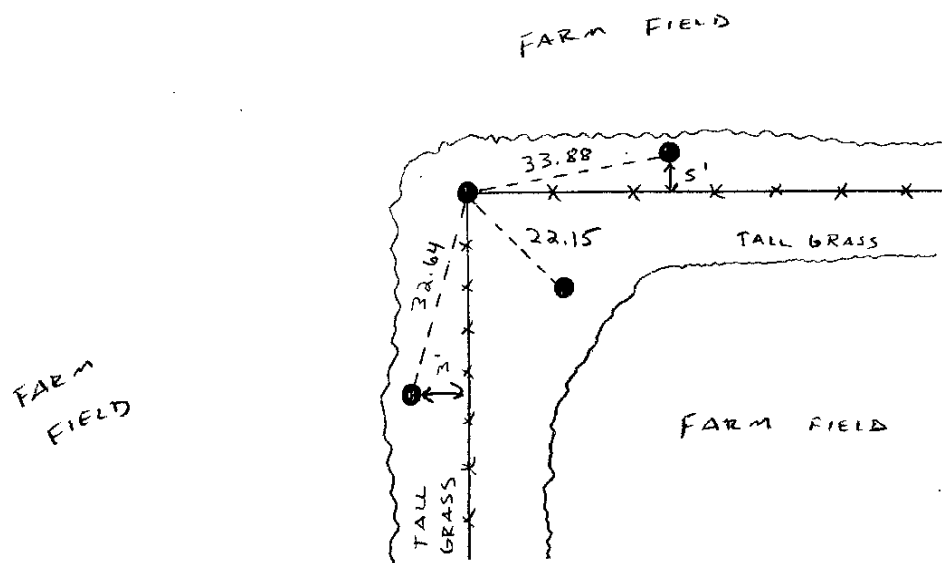
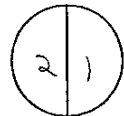

Statement of evidence for this corner location is on back of this page.

I hereby certify that this document was researched and prepared by me or under my direct supervision
and that I am a licensed Land Surveyor under the laws of the State of Minnesota.Signature Jerome C. Wittstock
Benton County Surveyor
License No. 19552Date: 19 March 2018PAGE 1 OF 2

Benton County Surveyor's Office
Jerome C. Wittstock, County Surveyor
Minnesota License No. 19552

Statement of Evidence:

D023

East Quarter Corner of Section 2, Township 38 North, Range 31 West, East Langola Township, 4th Principal Meridian, Benton County, Minnesota.

- 1852 Original US General Land Office survey set a wood post in a mound with a pit 8 links east at the corner location.
- 2002 No record evidence found on this corner in Benton County offices.
- 2011 The Benton County Surveyor's Office searched for corner evidence and found a fence running to the east and south. The fence corner measures 2671.13 to the southeast corner and 2763.02 feet to the northeast corner of said Section 2, compared to GLO of 2640 and 2808.30 feet, being 31 feet long of GLO for the half mile south and 45 feet short of GLO distance to the north. Distance in Benton County vary greatly by half mile so the distances appear to fit within reason. Since the long standing line of occupation fits distances reasonably well, a 1/2" x 14" iron pipe capped 19552 was set to mark the corner position.

County Coordinates obtained by GPS
NAD 83 (1996 Adjustment)
N- 193565.985
E- 473007.560